

211 GEORGIA ST.



TECH SPACE  
**FOR SUBLEASE**

FULLY IMPROVED  
**FOR IMMEDIATE OCCUPANCY**



**ALAIN RIVERE**  
SALES ASSOCIATE  
**604 662 5110**  
alain.rivere@cbre.com



LOCATED ON THE CORNER OF EAST GEORGIA AND MAIN STREET IN VANCOUVER'S RAPIDLY EVOLVING CHINATOWN DISTRICT.

## BUILDING FEATURES

- On-site property management.
- On-site parking.
- 24-hour secured access.
- Great location for designers, tech firms, and other creative companies.
- Close to downtown and the Main Street or Stadium SkyTrain stations with abundance of restaurants, coffee shops and other amenities.

## PROPERTY DETAILS

<b>SUITE</b>	105
<b>AREA (APPROX.)</b>	1,878 SF
<b>SUBLEASE RATE</b>	Contact Agent
<b>OP. COSTS</b>	\$10.05 PSF (est.)
<b>AVAILABILITY</b>	Immediately

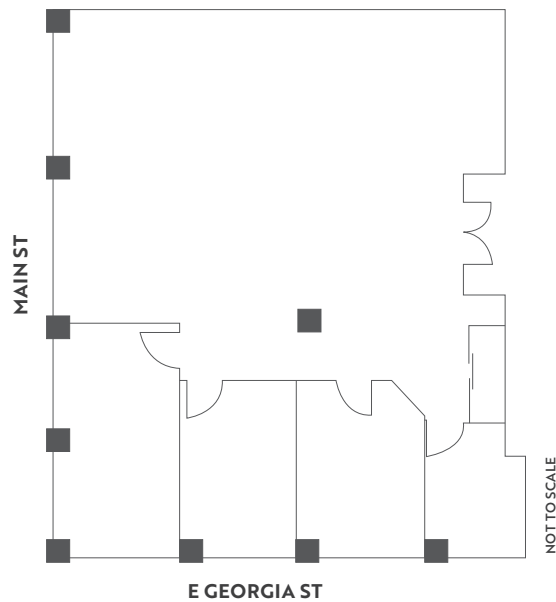

- FULLY IMPROVED**
- 4 MEETING ROOMS OR OFFICES**
- EXPOSED CEILING**
- CONCRETE FLOORING**
- LARGE OPEN AREA**



CBRE Limited | 1021 West Hastings Street | #2500 | Vancouver, BC V6E 0C3 | www.cbre.ca

This disclaimer shall apply to CBRE Limited, Real Estate Brokerage, and to all other divisions of the Corporation, to include all employees and independent contractors ("CBRE"). The information set out herein, including, without limitation, any projections, images, opinions, assumptions and estimates obtained from third parties (the "Information") has not been verified by CBRE, and CBRE does not represent, warrant or guarantee the accuracy, correctness and completeness of the Information. CBRE does not accept or assume any responsibility or liability, direct or consequential, for the Information or the recipient's reliance upon the Information. The recipient of the Information should take such steps as the recipient may deem necessary to verify the Information prior to placing any reliance upon the Information. The Information may change and any property described in the Information may be withdrawn from the market at any time without notice or obligation to the recipient from CBRE. CBRE and the CBRE logo are the service marks of CBRE Limited and/or its affiliated or related companies in other countries. All other marks displayed on this document are the property of their respective owners. All Rights Reserved. Mapping Sources: Canadian Mapping Services canadamapping@cbre.com; DMTI Spatial, Environics Analytics, Microsoft Bing, Google Earth.

211 E GEORGIA

105  
RELIQ HEALTH  
TECHNOLOGIES  
INC.  
211 F GEORGIA ST.

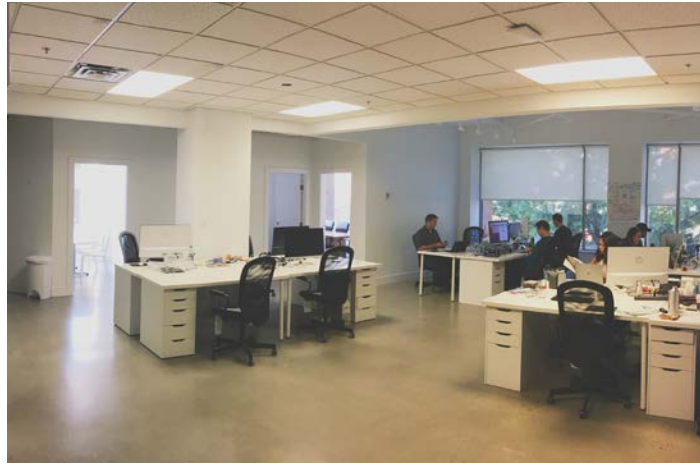

**ALAIN RIVERE**  
SALES ASSOCIATE  
ADVISORY & TRANSACTION SERVICES  
**THE HIGH TECHNOLOGY FACILITIES GROUP**  
**604 662 5110**  
[alain.rivere@cbre.com](mailto:alain.rivere@cbre.com)