

FOR SUBLEASE

1168 HAMILTON STREET, VANCOUVER, BC
BRICK & BEAM YALETOWN
OFFICE SPACE



CONTACT

KEVIN NELSON

Executive Vice President, The HTFG
Personal Real Estate Corporation
+1 604-662-5155
kevin.nelson@cbre.com

BLAIR QUINN

Vice Chairman, The HTFG
Personal Real Estate Corporation
+1 604-662-5161
blair.quinn@cbre.com

HT
FG

THE HIGH
TECHNOLOGY
FACILITIES GROUP

CBRE

PROPERTY DETAILS

FLOOR	4 th Floor
AREA	8,962 SF
ASKING RATE	Contact Listing Broker
TAXES & OP COSTS	\$16.67 PSF (2020 Est.)
OCCUPANCY	Immediate
TERM	June 29, 2024

HIGHLIGHTS

- 108+ workstations
- Open office area
- Collaboration space
- 5 meeting rooms
- Brick and beam detail
- 2 kitchens
- 2-minute walk to Yaletown-Roundhouse SkyTrain Station, providing easy connection to all parts of the Lower Mainland

[CLICK TO TOUR VIRTUALLY](#)

This disclaimer shall apply to CBRE Limited, Real Estate Brokerage, and to all other divisions of the Corporation; to include all employees and independent contractors ("CBRE"). The information set out herein, including, without limitation, any projections, images, opinions, assumptions and estimates obtained from third parties (the "Information") has not been verified by CBRE, and CBRE does not represent, warrant or guarantee the accuracy, correctness and completeness of the information. CBRE does not accept or assume any responsibility or liability, direct or consequential, for the information or the recipient's reliance upon the information. The recipient of the information should take such steps as the recipient may deem necessary to verify the information prior to placing any reliance upon the information. The information may change and any property described in the information may be withdrawn from the market at any time without notice or obligation to the recipient from CBRE. CBRE and the CBRE logo are the service marks of CBRE Limited and/or its affiliated or related companies in other countries. All other marks displayed on this document are the property of their respective owners. All Rights Reserved. Mapping Sources: Canadian Mapping Services canadamapping@cbre.com; DMTISpatial, Environics Analytics, Microsoft Bing, Google Earth



Open Office

FLOOR PLAN*

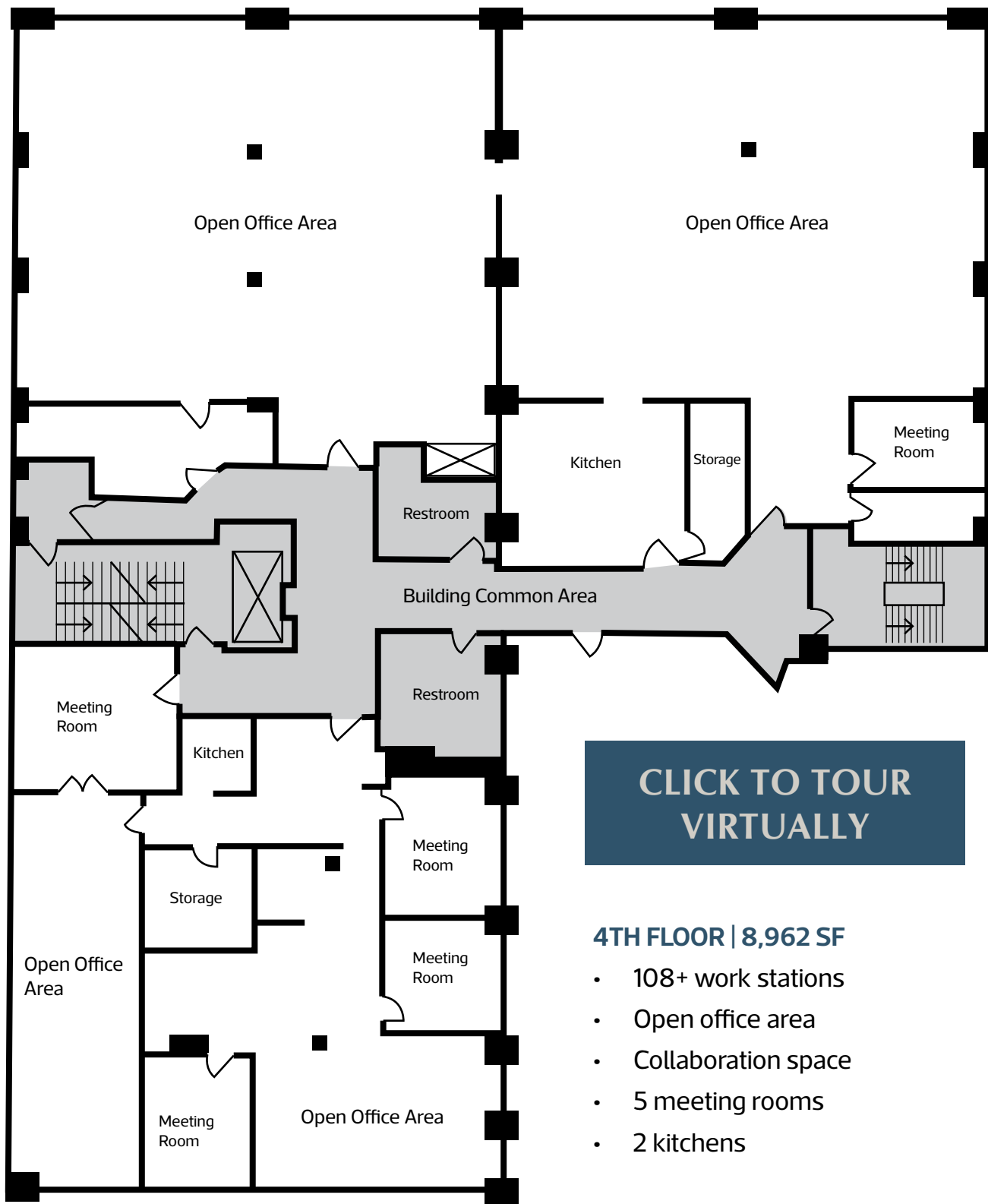

[CLICK TO TOUR VIRTUALLY](#)

4TH FLOOR | 8,962 SF

- 108+ work stations
- Open office area
- Collaboration space
- 5 meeting rooms
- 2 kitchens

*Floor plan not to scale



Open Office



Meeting Room



Collaboration Area



Kitchen



Meeting Room

THE LOCATION

1168 Hamilton Street is desirably located in the heart of Yaletown. The historic, modernized neighbourhood is home to some of Vancouver's trendiest and most sought-after restaurants, cafes and amenities. The space provides seamless connection to all parts of the Lower Mainland with Yaletown-Roundhouse Skytrain Station a quick 2-minute walk away, the iconic Seawall a 6-minute walk away, and several bus routes that service the area.

NEARBY AMENITIES

Cactus Club
MeeT in Yaletown
Minami
Tacofino
The Flying Pig
The Keg
The New Oxford
The Parlour

Brix & Mortar
Yaletown Brewing Company
Blenz Coffee
JJ Bean Coffee Roasters
Small Victory Bakery
Choices Markets
Shoppers Drug Mart
Urban Fare

Bank of Montreal
CIBC
RBC Royal Bank
TD Canada Trust
Barre Fitness
Soul Cycle
YYOGA

WALK SCORE



100

RIDER'S
PARADISE



97

WALKER'S
PARADISE



85

VERY
BIKEABLE

walkscore.com



1168 Hamilton Street

Yaletown-Roundhouse
SkyTrain Station



CONTACT

KEVIN NELSON

Executive Vice President, The HTFG
Personal Real Estate Corporation
+1 604-662-5155
kevin.nelson@cbre.com

BLAIR QUINN

Vice Chairman, The HTFG
Personal Real Estate Corporation
+1 604-662-5161
blair.quinn@cbre.com

HT
FG

THE HIGH
TECHNOLOGY
FACILITIES GROUP

CBRE